

AEM® Monitor Setup Sheet

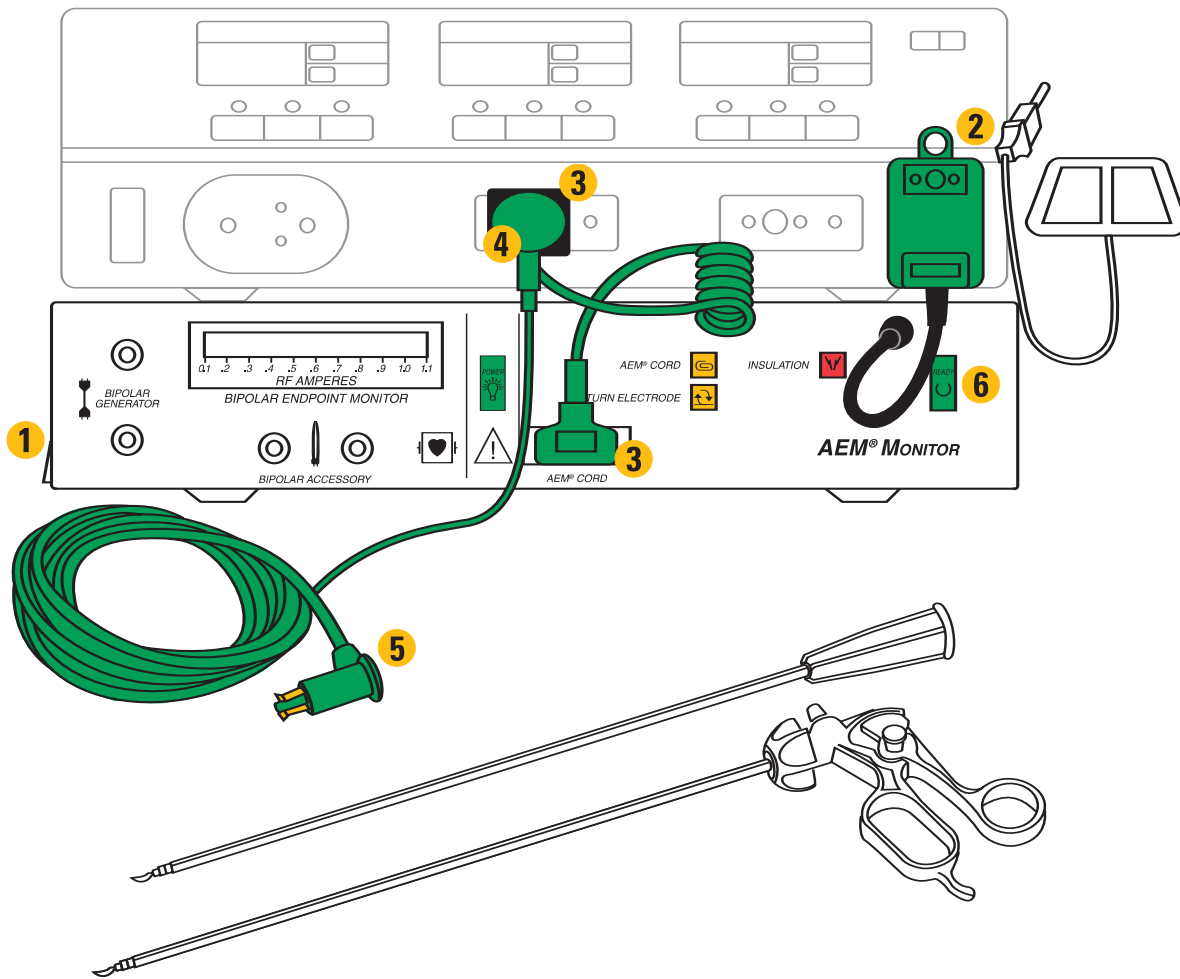

- 1 Locate the on/off switch located on the side of the AEM Monitor and turn it on. Verify that all visual indicators illuminate and two beeps are heard.
- 2 Plug the green **INHIBIT ADAPTER** into the ESU return electrode receptacle. Then plug the return electrode into the adapter. Verify the amber RETURN ELECTRODE light turns off.
- 3 Plug the cylindrical end of the **AEM CORD ADAPTER** into the ESU, plug the other end into the AEM CORD receptacle of the AEM Monitor.
NOTE: Do not sterilize the **AEM CORD ADAPTER**.
- 4 Plug either end of the **AEM CORD** into the **AEM CORD ADAPTER**.
- 5 Plug the other end of the **AEM CORD** into the instrument of choice.
- 6 Verify the amber AEM CORD light turns off and the green READY light is on. The AEM Monitoring System is READY to function.

ENCISION recommends that a backup AEM Cord and AEM Cord Adapter be available at all times.

ENCISION®

ENCISION INC.
6797 Winchester Circle
Boulder, CO 80301 USA
303-444-2600 • Fax 303-444-2693 • 800-998-0986

CE1275 EM2+E only

EC REP – according to MDD93/42/EEC
MDSS GmbH
Schiffgraben 41
30175 Hannover, Germany

©Copyright 2010
Printed in USA 00701-008

Bipolar Endpoint Monitor Setup

STEP 1

Place the Electrosurgical Unit (ESU) on top of the AEM Monitor and plug both units into power receptacles.

STEP 2

Turn on both the AEM Monitor and ESU.

STEP 3

Plug one end of the **BIPOLAR JUMPER CABLE** into the vertical pair of jacks on the AEM Monitor labeled BIPOLAR GENERATOR, the other end into the ESU bipolar output jacks.

STEP 4

Plug the cord from the Bipolar Accessory into the horizontal pair of jacks labeled BIPOLAR ACCESSORY on the AEM Monitor.

STEP 5

The Bipolar Accessory is ready to function as usual.

STEP 6

The front panel display will indicate the intensity of the RF current being delivered to the accessory. The volume can be adjusted to OFF, LOW and HIGH by the VOLUME CONTROL switch on the AEM Monitor back panel.

Notice: If both monopolar and bipolar functions are being used, the monopolar instrument must remain connected to avoid spurious alarms.

AEM® Monitor Trouble Shooting Guide

INDICATORS

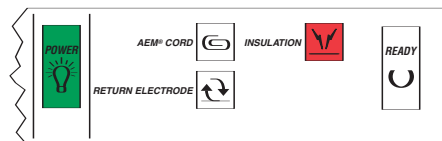
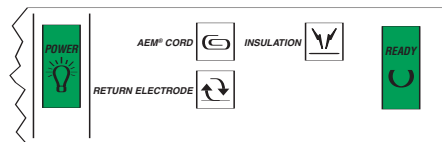
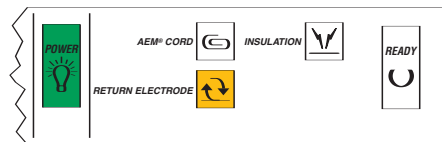
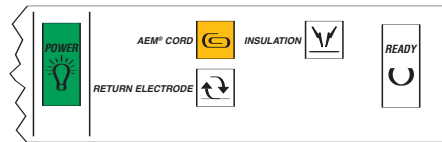
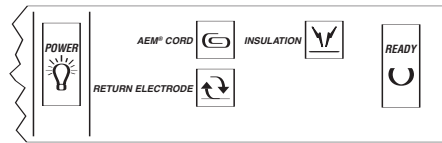

See Manual
for Warnings
and Cautions

CORRECTIVE ACTION

- Verify power cord plugged in.
- Turn power switch OFF for 30 seconds, then ON.
- Connect AEM Cord to instrument.
- Connect AEM Cord to AEM Cord Adapter.
- If fault persists, replace AEM Cord.
- If fault persists, replace AEM Cord Adapter.
- Verify proper return electrode is being used.
- Verify Return Electrode Plug is pushed completely into green Inhibit Adapter.

ESU should function, if it does not:

- Verify green Inhibit Adapter is firmly secured into the ESU.
- Reset ESU Pad Monitor.
- Remove green Inhibit Adapter and plug Return Electrode Cord into the ESU. If ESU functions, replace Monitor. Contact ENCISION Technical Support at 800-998-0986.

CAUTION: Do not use the AEM Monitor without the Inhibit Adapter plugged into the ESU return electrode receptacle. The Inhibit Adapter allows the AEM Monitor to signal the ESU when an insulation or contact failure is detected.

- 1st – replace AEM Laparoscopic Instrument.
- 2nd – replace AEM Cord.
- 3rd – replace AEM Cord Adapter.

Note: If the CORRECTIVE ACTION fails to restore proper functioning, call ENCISION Technical Support at 800-998-0986.